

## ■ Facility Overview

The 2<sup>nd</sup> and 3<sup>rd</sup> floor classrooms of the former Yonesaki Jr. High School will be partially renovated to accommodate various purposes.

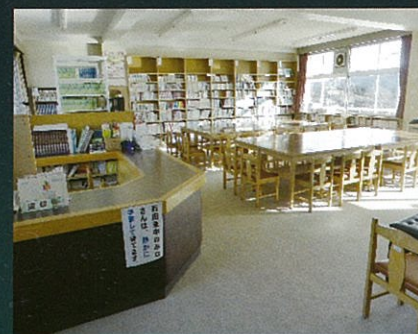

Workshop Room

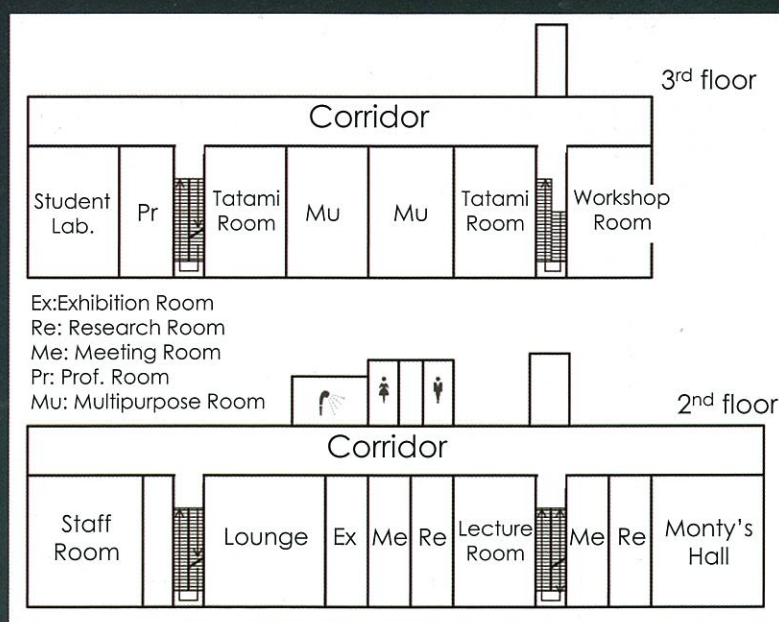

Auditorium(Monty's Hall)



Lecture Room

[Facilities to be developed]

Auditorium / Lecture Room / Workshop Room  
Tatami Room / Multipurpose Room /  
Lounge / Shared Lab (collaborative research lab)  
/ Meeting Room / Research Room / Office /  
Exhibition Room / Shower Booth

## ■ Access (driving is recommended to access the Campus)



Map of Rikuzentakata City



Map of the Global Campus area

From Ofunato  
Drive South on Route 45  
to Kesennuma. After  
passing "Sanchoku  
Hamanasu," get off 45  
and turn left at the T-  
intersection. Drive 600m.

From Kesennuma  
Drive North on Route 45  
to Ofunato. Turn right at  
the Yonesaki Post Office  
intersection and drive  
300m.

# Rikuzentakata Global Campus

Open  
April 2017

Operated by  
Iwate University and Rikkyo University

Name: Rikuzentakata Global Campus  
Nickname: Takata-no-yume Campus  
Operated by: Iwate University and Rikkyo University  
Location: 113 Kamida, Yonesaki-cho, Rikuzentakata,  
Iwate (Former Yonesaki Jr. High School)

Contact: Regional Cooperation/COC Promotion  
Division, Iwate University  
Phone: +81-19-621-6624, Fax: +81-19-621-6999  
Email: rtgc@iwate-u.ac.jp  
(tentative contact information until March 2017)

Production: Rikuzentakata City, Iwate University, Rikkyo University, Council for Promoting Cooperation,  
Planning and Steering Committee (produced in November 2016)  
Rikuzentakata Global Campus is currently under construction, and the content of this leaflet is subject to  
change.



## ■What is Rikuzentakata Global Campus?

Rikuzentakata Global Campus (RTGC) is jointly established by Iwate University and Rikkyo University as a public facility supported by the City of Rikuzentakata. This is considered to be a very unique initiative in Japan, comprising two academic institutions, one national and one private university.

RTGC will be utilized as a hub flexibly used for exchange, study, and research among students and researchers of any university inside or outside Japan, as well as employees of the business sector and local governments.



## ■3 Concepts of the Program

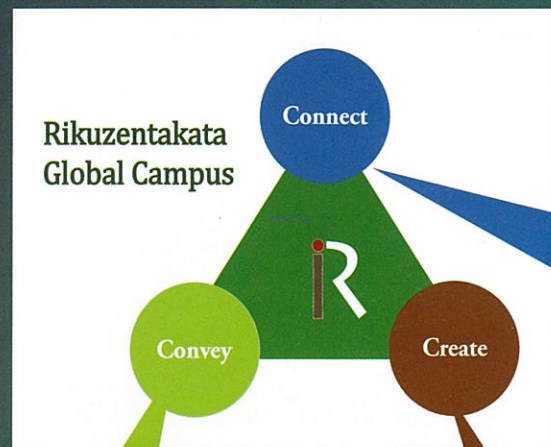

Rikuzentakata Global Campus organizes various programs to fulfill the concept with the following:

“Connect through learning”  
“Communicate through learning”  
“Create through learning”

### ◆ “Connect”

The Campus connects various entities, especially:

- Rikuzentakata (citizens) and the university
- Universities
- Japan and Overseas

### ◆ “Convey”

Visualize the Great East Japan Earthquake and tsunami, the unparalleled reconstruction and urban planning afterwards, and the lessons learned in order to convey messages to various entities. The messages they convey are not limited to “post-disaster,” but also include rich tradition, history, and culture that the city possesses.

### ◆ “Create”

University students and researchers, citizens of Rikuzentakata, “citizens of the heart” (non-citizens who care about Rikuzentakata), and various other persons who come together to share wisdom and expand upon the future of the city as well as the future of Japan.

## ■As an Open Space

Rikuzentakata Global Campus welcomes anyone who wishes to utilize the space. The Campus is available for the following purposes among others. Feel free to inquire (consult on the fees and charges separately).

- ◆ Meetings, training, workshops
- ◆ Academic programs (see the page on the right)
- ◆ Collaborative laboratory, Shared Lab (see the page on the right)
- ◆ Activity hub for intensive courses, seminars, research work for visitors to Rikuzentakata
- ◆ Symposiums, exchange programs, collaborative events

## ■Prospective Projects

Since its opening in 2017, diverse projects have been planned based on the three concepts including (tentatively):

Connect

Convey

### ★ Rikuzentakata University Symposium

An annual event to provide a venue to bring citizens together with university members from all over Japan who have connections with Rikuzentakata

Connect

Create

### ★ Collaborative laboratory, Shared Lab

A rental lab space for graduate and undergraduate students and young researchers from universities throughout Japan and beyond. The lab can be used on a weekly or yearly basis for research work.



Connect

### ★ Rikuzentakata Community College Courses

Cultural and practical courses mainly targeting Rikuzentakata citizens. Courses are provided under different themes inviting university researchers, celebrities from various fields, and people who have a connection with Rikuzentakata based on the university's knowledge network.



Connect

Convey

Create

### ★ Development and hosting of academic programs

As of 2017, Iwate University and Rikkyo University have developed the following programs. (see below) They will be implemented publicly and invite participants from all over Japan and abroad.

#### Rikuzentakata Global Program (mainly for undergraduate and graduate students)

An international academic program where students from Japan and abroad jointly deepen their learning through conversation and exchange. They will have hands-on learning opportunities on the damage caused by disasters and the subsequent processes of reconstruction.

#### Rikuzentakata University of Disaster Management (mainly for municipal staff throughout Japan)

An advanced practical program for disaster management based on the actual experience of the Great East Japan Earthquake and tsunami. Students will learn how shelters and residents' safety are secured.



Convey

Create

### ★ “Oral Heritage” (video archive project)

A potential video project to pass citizens' stories on to rest of Japan and the world, and to future generations.

